

INOGENONE



7 Simple Steps to Independence.

INOGEN ONE

Now that you have unpacked each box, you have everything you need to start using your Inogen One (IO-100). The set-up of your Inogen One is quick and simple. However, before using the Inogen One, please read the entire Patient Manual.

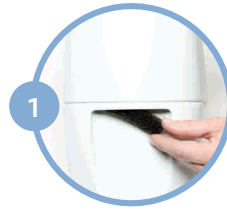

1 Place your Inogen One in a well ventilated location. Ensure the particle filter is in place.



2 Insert your Inogen One Battery into the battery compartment with the handle of the battery up. The battery will only fit one way, and easily slides into place as shown.



3 Connect your Inogen One AC Power Supply cord to the AC Power Supply. Connect the AC Power Supply to your Inogen One.



4 Plug the AC Power Supply cord into the nearest electrical outlet.



5 Connect the nasal cannula tubing to the metal nozzle on your Inogen One.



6 Turn on the Inogen One by pressing the ON/OFF button.



7 Set the flow setting to the flow rate prescribed by your physician. The flow setting can be changed by pressing the triangular flow setting buttons that are marked with “+” and “-” symbols. Position the nasal cannula on your face and breathe normally through your nose.



Car/Boat/RV Usage

After you are familiar with operating your Inogen One at home, you are ready to take your Inogen One on the road.

As always, be a careful driver. DO NOT RUSH OR HURRY to set up your Inogen One in the car. Take your time and follow the steps outlined to the right. The Inogen One can operate either by battery or the Mobile Power Charger while in your car, boat, or RV. If using the Mobile Power Charger, the battery will charge.

CAUTION

Make sure your Inogen One is secure before driving.



Plug the Mobile Power Charger into the cigarette lighter or auxiliary DC power supply.



Plug the Mobile Power Charger into your Inogen One and position your Inogen One securely inside the car. Operate your Inogen One as normal.



120 Cremona Drive, Suite B
Goleta, CA 93117
1-877-4-INOGEN (Toll Free)
1-877-446-6436 (Toll Free)
www.inogen.net
www.OxygeNation.com

Your Equipment Provider:

Your Physician:

